

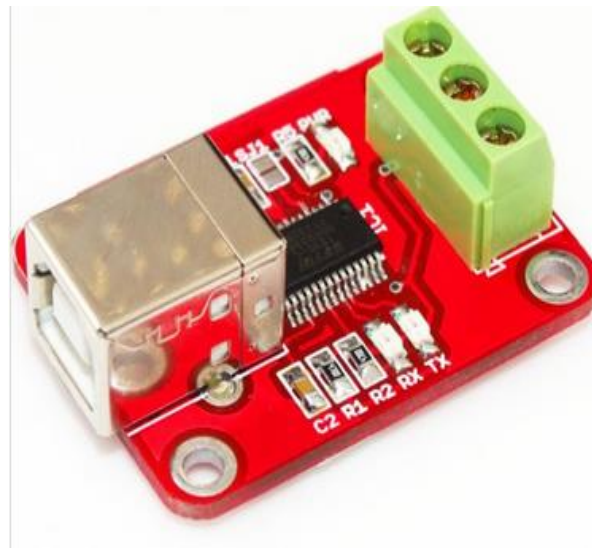

USB TO RS485 CONVERTER



Contents

OVERVIEW	3
USB TO RS485 CONVERTER	3
RS485 IC	3
FEATURES	4
CONNECTION DIAGRAM	4
RELATED PRODUCTS	5

OVERVIEW

USB TO RS485 CONVERTER

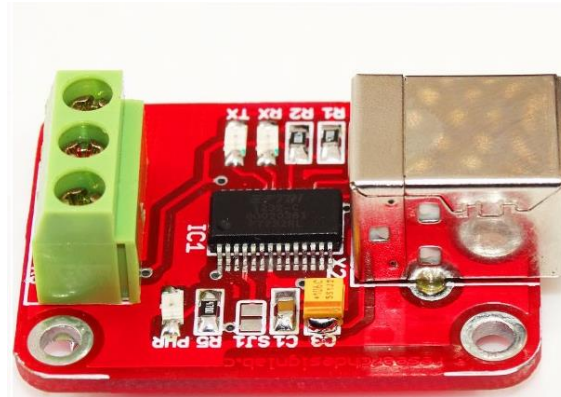

The USB-RS485 is a fully automatic plug-and-play USB module that connects to your PC via the Universal Serial Bus (USB) port and provides robust USB to RS-485 protocol conversion with automatic RS-485 flow control. This converter provides two way serial communications signal conversion between the RS485 to and from a personal computer USB port using virtual serial COM port. Using the USB-RS485 module , one can connect upto 32 RS-485 devices simultaneously to a single USB port. Typically it is used for multi-drop communication.

The USB-RS485 module provides an easy to use RS485 interface by means of a Virtual Com Port on the users system. The module is completely self powered from the USB bus. Simply use the standard COM-port interface to automatically connect RS-485 over USB.

RS485 IC



FEATURES

- Self powered from USB.
- Easy to use and small size.
- USB2.0 standard.
- Baud rate :2400-921600bps.
- Supports devices with RS485 interface: surveillance cameras, video capture device, fingerprint attendance machine.

CONNECTION DIAGRAM

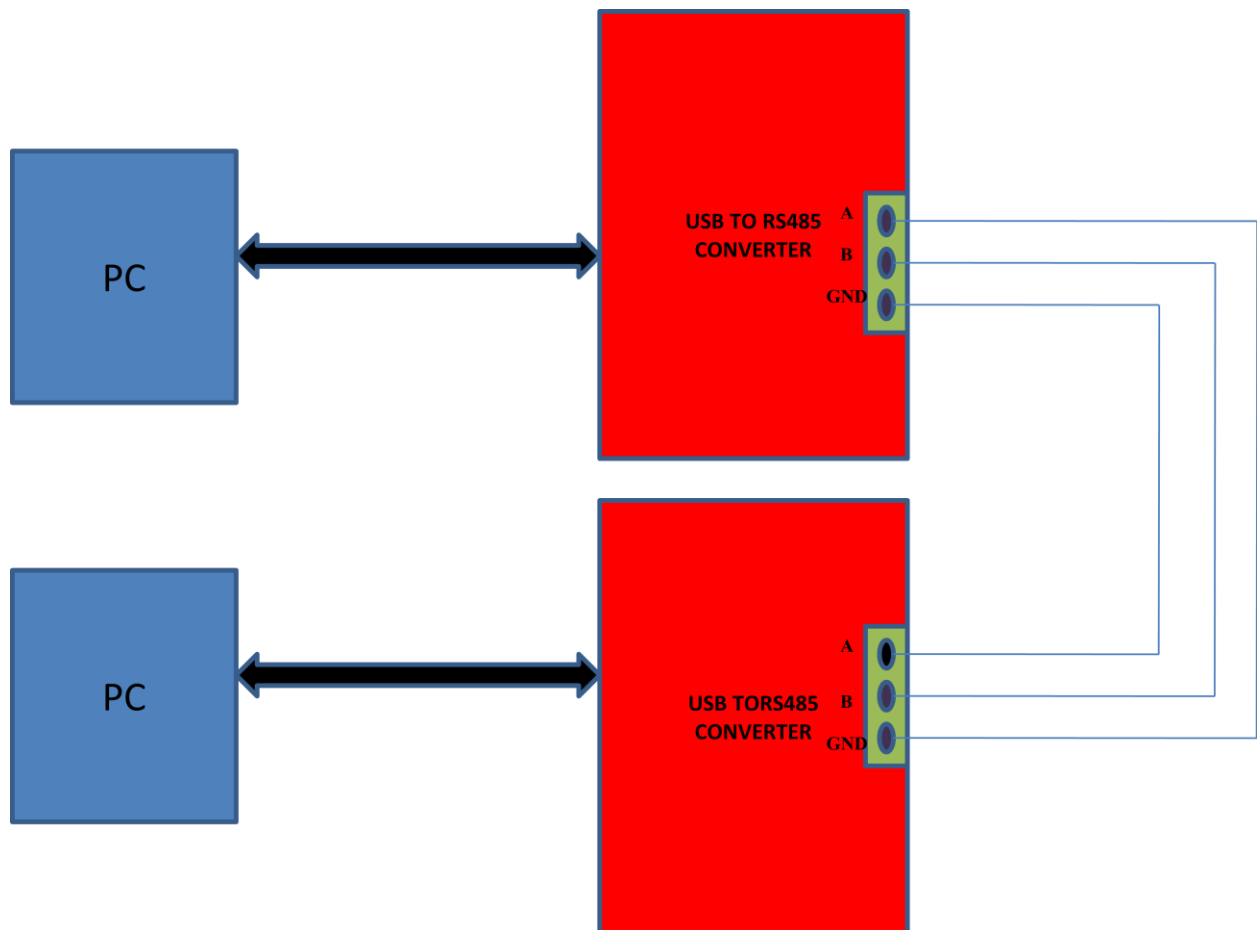

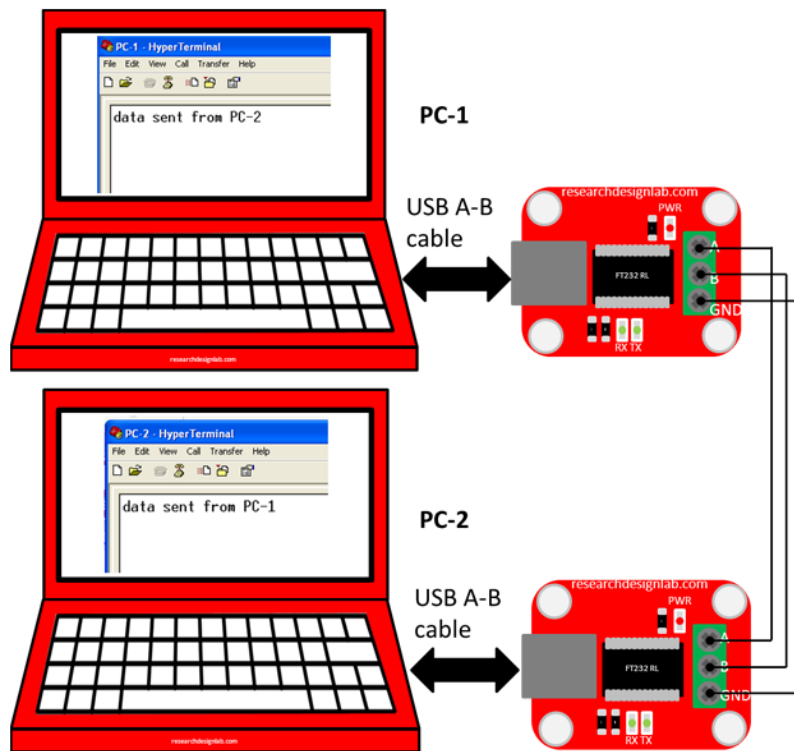



RELATED PRODUCTS

8 CHANNEL RELAY BOARD

LCD KEYPAD SHIELD

